

SPECIFICATIONS

			5050
			TC5050WVD22- 3CESR3



Version No			



<http://www.cled.co>



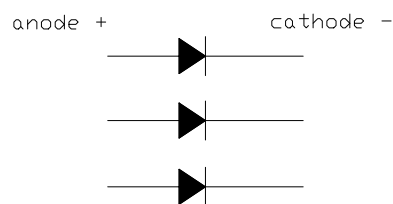
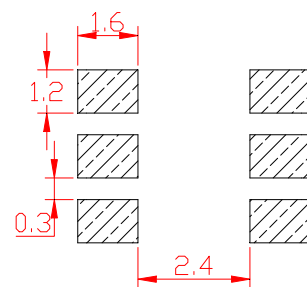
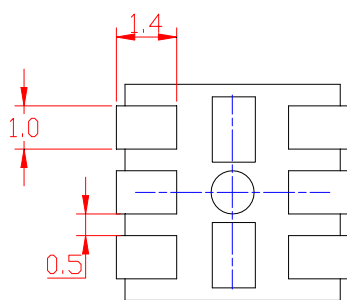
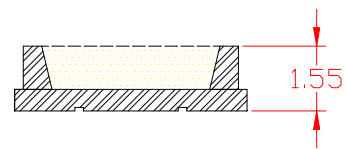
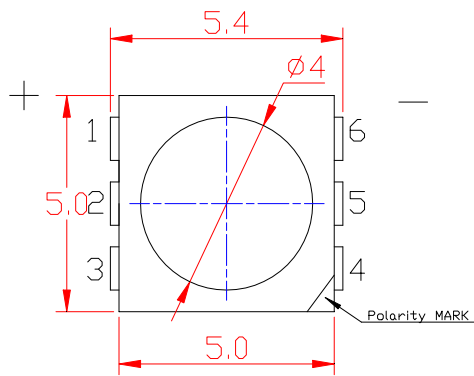

1. All dimensions are in millimeters
Tolerances are $\pm 0.2\text{mm}$ unless otherwise noted

Parameters	Symbol	Value	Unit
Power Dissipation	Pd	200	mW
Forward Current	IF	60	mA
Pulse Forward Current	IFP	100	mA
Reverse Voltage	VR	5	V
Electrostatic Discharge	ESD	2000(HBM)	V
Operating Temperature	Topr	-40 +85	
Storage Temperature	Tstg	-40 +100	

Item	Symbol	Mix	Typ	Max	Unit	Conditions
Forward voltage	VF	2.8		3.2	V	IF=60mA
Reverse current	IR	--	--	5	A	VR = 5V
Chromaticity	TC	2600	--	2800	K	IF=60mA
		2800	--	3200		
		3800	--	4200		
		4800	--	5200		
		6000	--	6500		
Color Rendering	Ra	80	--	85	/	IF=60mA
Viewing angle ()	2 θ 1/2		120		Deg	IF=60mA
Luminous intensity		22	--	24	Lm	IF=60mA
Color tolerance	SDCM	--		4		IF=60mA

(Tolerance: I_v ±10%, λ_d ±2nm, V_f ±0.05V)

I_v ±10%, λ_d ±2nm, V_f ±0.05V

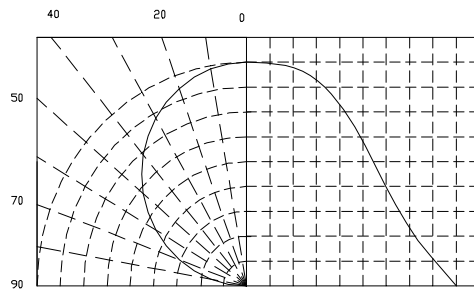
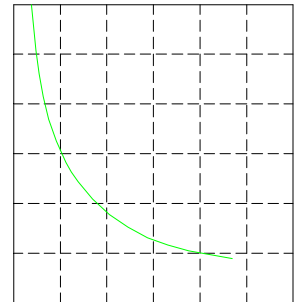
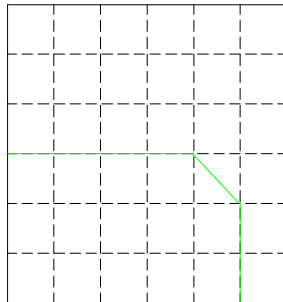
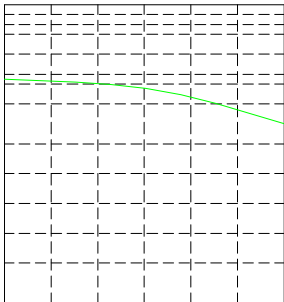
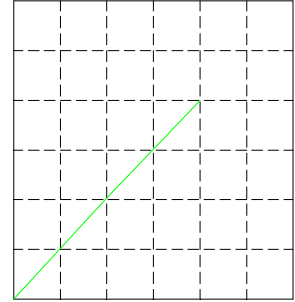
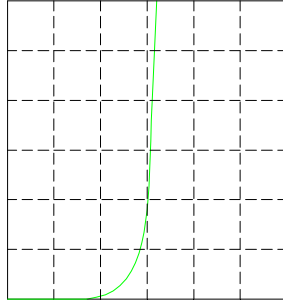
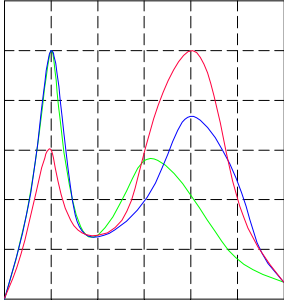

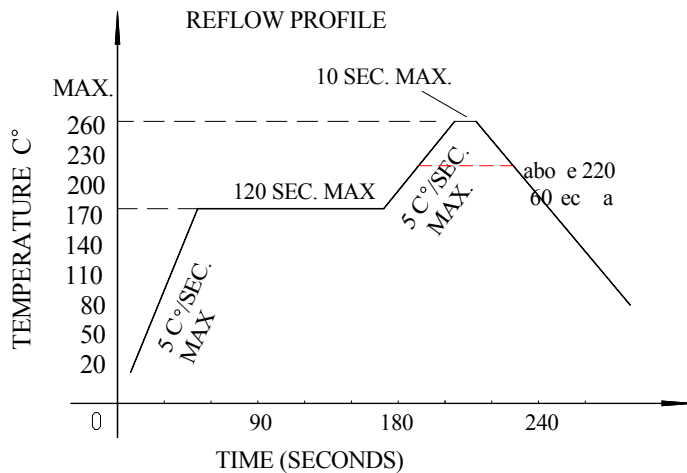

1. Reflow soldering should not be done more than two times
2
2. When soldering ,do not put stress on the LEDs during heating
LED

1. When hand soldering, keep the temperature of the iron under 300 , and at that temperature keep the time under 3 sec.
300 3
2. The hand soldering should be done only a time

1. Customer must finish rework within 5 sec under 260
260 5
2. The head of iron can not touch the LEDs
LED
3. Twin-head type is preferred.

The encapsulated material of the LEDs is silicone. Therefore the LEDs have a soft surface on the top of package. The pressure to the top surface will be influence to the reliability of the LEDs. Precautions should be taken to avoid the strong pressure on the encapsulated part. So when using the picking up nozzle, the pressure on the silicone resin should be proper.

LED

LED

LED

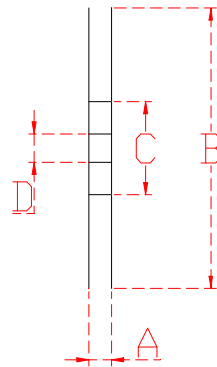
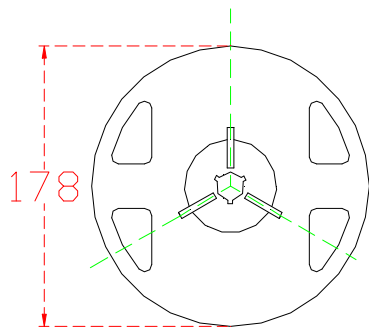
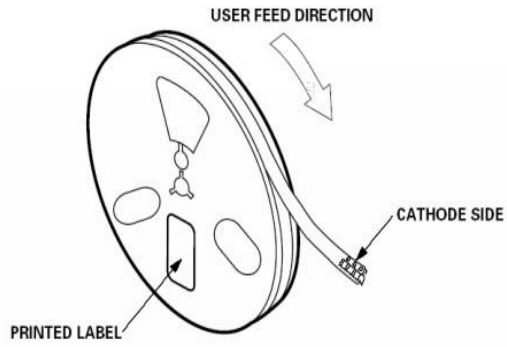

A	8.0	0.1
B	178	1
C	60	1
D	13.0	0.5

